

## PRODUCT INFO SHEET

### Accessories Set: Cells, Materials, and Tools for Coin Cell Assembly

#### Coin Cell Accessories

These specialized accessories are suited for the coin cell module for single-resonance (X-channel) static wide-bore probes to be used for the *in-situ/operando* NMR analysis of typical coin and pouch cells.

The accessories feature

- 2 × Coin cell adapters (made from PEEK or Teflon)
- 50 × Stainless steel coin cell assembly size CR2032 including top, bottom, spring, spacer, and gasket
- 20 × Titanium coin cell assembly size CR2032 including top, bottom, spring, spacer, and gasket
- 1 × Lab bench crimper for coin cell assembly
- 1 × Set of tools, accessories, and spares for NMR coin and pouch cell preparation

The coin cell module fits coin cells up to size CR2032 (e.g. made from stainless steel or Titanium) and pouch cells up to 25 x 24 x 7 mm (e.g. made from Aluminum). Details on the coin cell adapter assembly and setup with the probe are depicted on the next page.



## Coin Cell Adapter Assembly

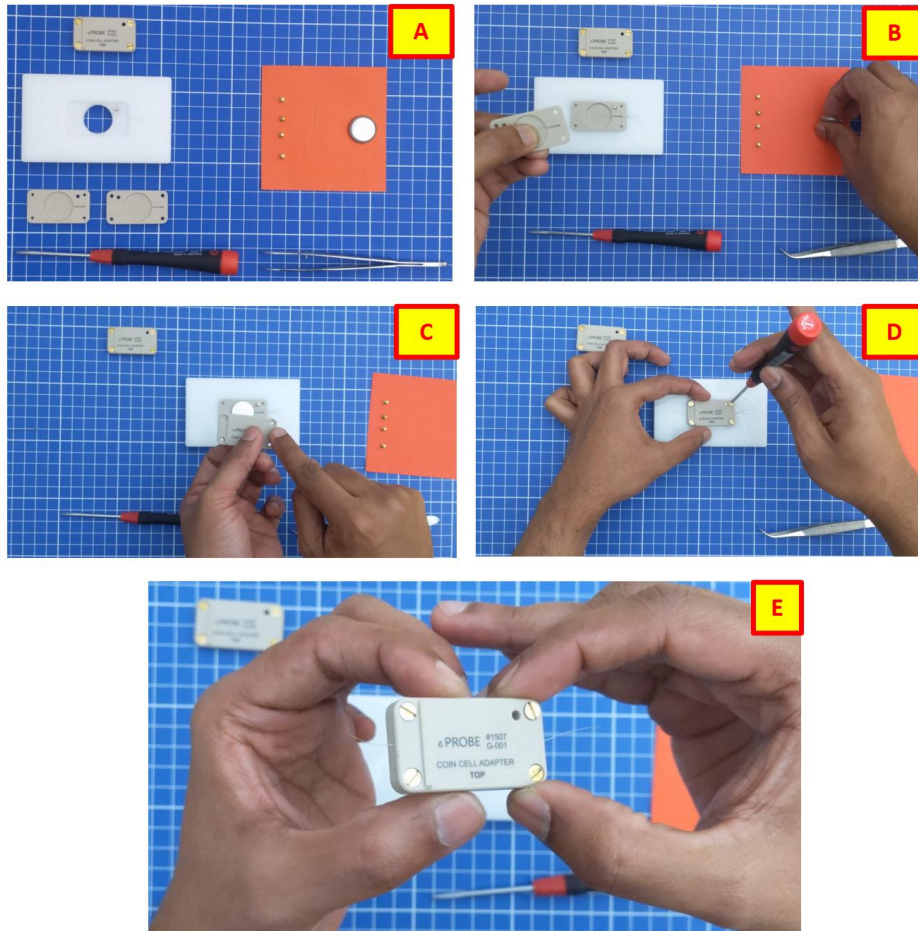

## Coin Cell Adapter Setup with the Probe

